

REDUTORES DE VELOCIDADE A ROSCA SEM FIM

FLANGE P/ MOTORES TIPO C-DIN

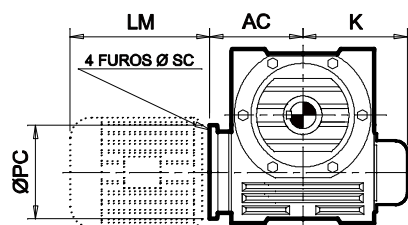

FLANGE P/ MOTORES TIPO F ou A

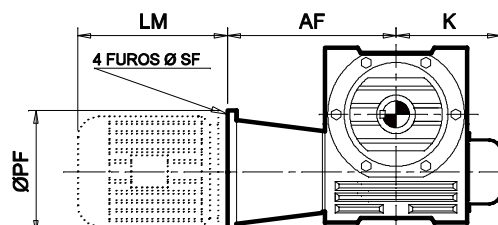

REDUTOR TIPO	MOTOR		K	FLANGE C-DIN 42677				FLANGE TIPO F				
	CARCAÇA	LM		TIPO	AC	PC	SC	TIPO	AF	PF	SF	ACOPLAMENTO
R6	80	234	154	C-120-6	121	120	6,5	A-165-6	126	200	12,0	—
	90	276		C-140-6	126	140	8,5	A-165-6	126	200	12,0	—
	100/112	327,5		C-160-6	130	160	8,5	A-215-6	146	250	15,0	—
R7	90	276	172	C-140-7	143	140	8,5	A-165-7	140	200	11,0	—
	100/112	327,5		C-160-7	143	160	8,5	A-215-7	144	250	15,0	—
	132	410,5		C-200-7	163	200	10,5	A-265-7	171	300	15,0	—
R8	90	276	200	—	—	—	—	A-165-8	171	200	11,0	—
	100/112	327,5		C-160-8	180	160	9,0	A-215-8	171	250	15,0	—
	132	410,5		C-200-8	178	200	10,5	A-265-8	188	300	15,0	—
R9	100/112	327,5	224	C-160-9	202	160	8,5	A-215-9	195	250	15,0	—
	132	410,5		C-200-9	207	200	11	A-265-9	212	300	15,0	—
	160	522,5		—	—	—	—	A-300-9	235	350	19,0	—
R10	100/112	327,5	349	—	—	—	—	A-215-10	250	250	15,0	—
	132	410,5		C-200-10	254	200	12	—	—	—	—	—
	160/180	522,5		—	—	—	—	A-300-10	260	350	19,0	—
R11	160/180	327,5	375	—	—	—	—	A-300-11	330	350	19,0	—
	200	410,5		—	—	—	—	A-350-11	330	400	19,0	—
	225	522,5		—	—	—	—	A-400-11	330	450	19,0	—
R12	160/180	327,5	483	—	—	—	—	A-300-12	390	350	19,0	—
	200	410,5		—	—	—	—	A-350-12	390	400	19,0	—
	225	522,5		—	—	—	—	A-400-12	390	450	19,0	—

POSIÇÃO DE SERVIÇO

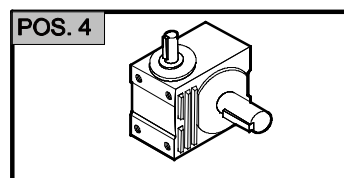
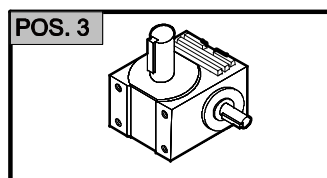
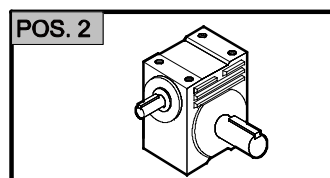
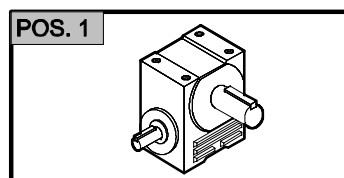

PESO APROXIMADO (Kg)

TIPO	REDUTOR	PÉ	BASE	FLANGE
R6	23,5	2,2	1,30	0,42
R7	41,5	3,7	8,0	2,6
R8	65	4,4	11,0	3,3
R9	100	8,0	18,0	3,8
R10	240	—	18,0	6,0
R11	450	—	27,0	11,0
R12	710	—	31,0	21,0

QUANTIDADE DE ÓLEO (litros) - ISO 680

TIPO	POS. 1	POS. 2	POS. 3	POS. 4
R6	1,1	1,1	1,6	1,5
R7	1,8	1,8	3,0	2,5
R8	2,5	2,5	4,0	3,5
R9	4,5	5,0	6,5	6,0
R10	10,0	15,0	17,0	17,0
R11	15,0	12,0	25,0	25,0
R12	35,0	28,0	59,0	59,0

CLASSIFICAÇÃO DE CARGAS CONFORME AGMA

TIPOS DE APLICAÇÃO	TEMPO DIÁRIO DE OPERAÇÃO	CLASSE AGMA	FATOR SERVIÇO
SEM CHOQUES/POUCAS PARTIDAS	10 HORAS DIA	I	1,0
VIBRAÇÕES	10 HORAS DIA	II	1,5
SEM CHOQUES/POUCAS PARTIDAS	24 HORAS DIA	II	1,5
CHOQUES FORTES/MUITAS PARTIDAS	10 HORAS DIA	III	2,0
VIBRAÇÕES	24 HORAS DIA	III	2,0